

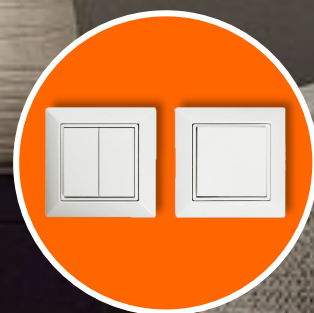

Radium
Die Lichtmarke



Bluetooth Control Wall Switch. User Manual.

Setting up your Wall Switch

The battery-less, energy harvesting, Bluetooth Low Energy switch modules can be paired to a Casambi network.

The switches can control individual luminaires, groups of luminaires, all luminaires in a network, scenes and animations.

Wall switches are added to the Casambi network in the following manner:

1. Go to More > **Switches** in your Android device
2. Click on "**Add a Dolphin Switch**"
3. Touch the switch with the back side of your mobile device, when NFC is activated.

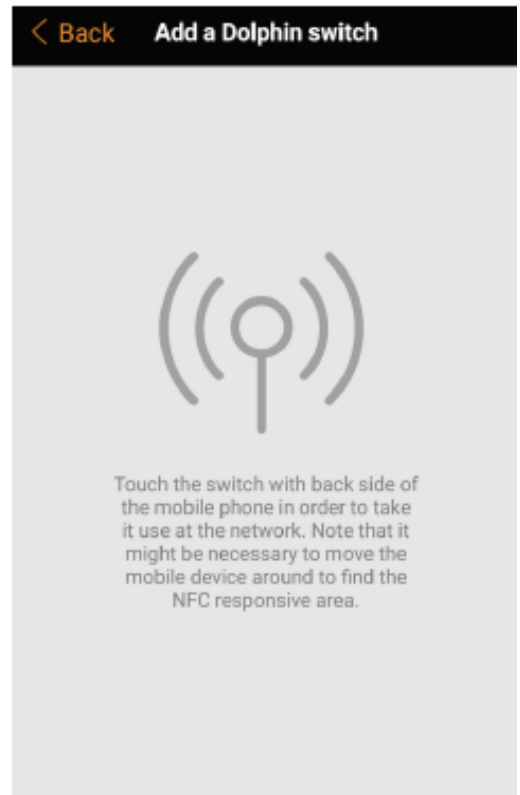
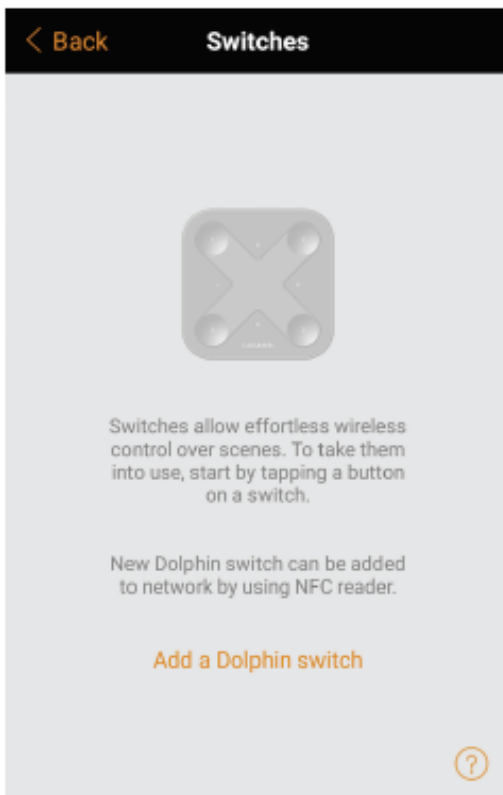

Setting up your Wall Switch

4. When the NFC reader of your mobile device detects the Dolphin switch you will hear a noise and switch list page is opened with the added Dolphin switch.

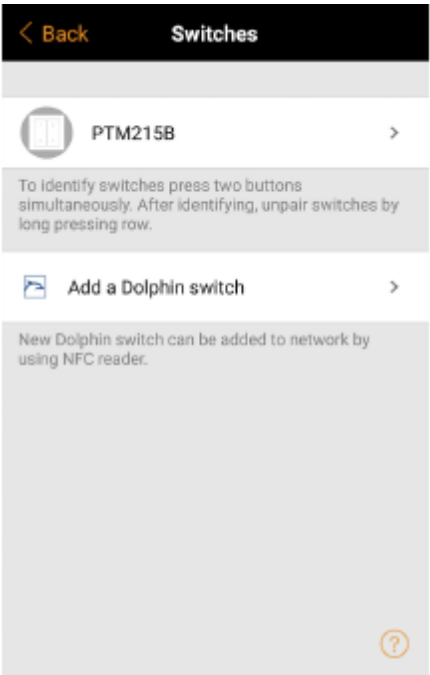

5. When you click on the switch a configuration page for the switch is opened. Here you can configure the functionality of your switch, change the name and the faceplate. Please make sure you have the correct faceplate before you start configuring.

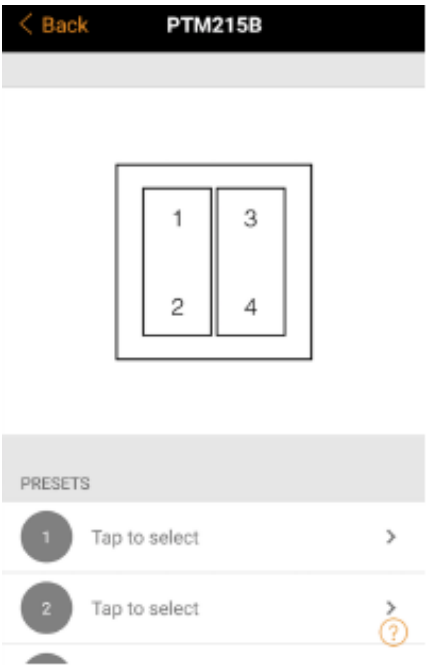

Setting up your Wall Switch

6. By clicking on the faceplate picture (as a default the Casambi app will show the 4 button faceplate) you will be directed to a list of all possible faceplate options. Choose the one to match your Dolphin switch. The scope of delivery contains single- and double rocker. The faceplate in the app which are marked with + or – symbol are designated for dimming up and down. You can also control the colourtemperature of a tunable white luminaire by the lower faceplate.

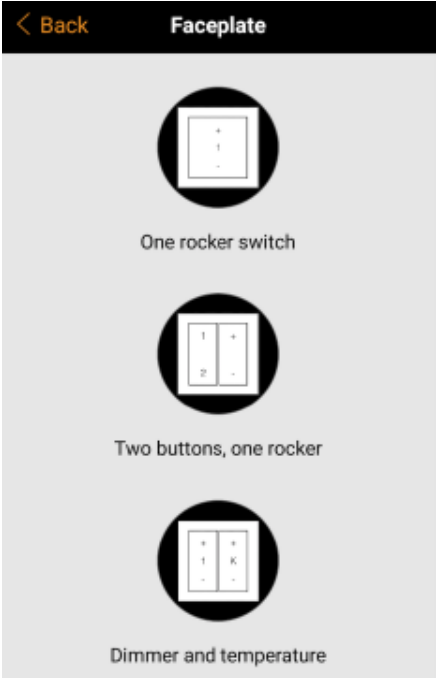
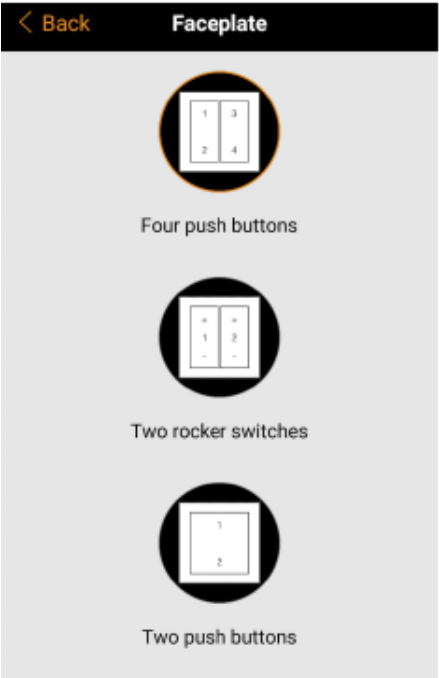

7. Now you can choose the luminaire, luminaire-group or scene, which should be controllable, by tipping on > in pre-settings.

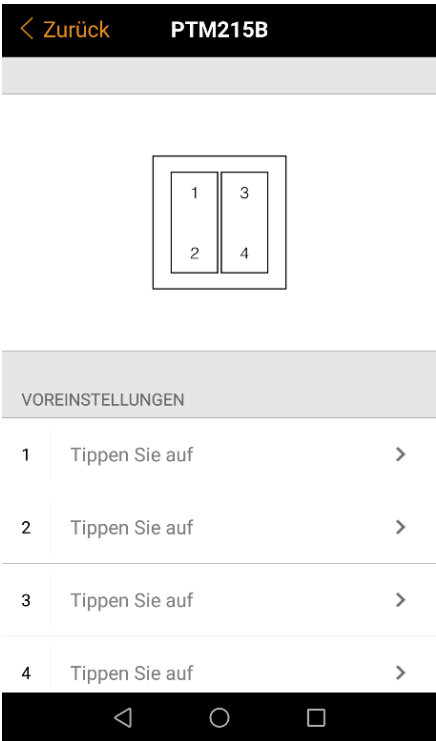
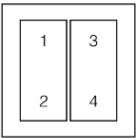

Handling your Wall Switch

The handling of the luminaires with the switch varies depending on the facetape.

Generally the deposited scene can be switched on and off by short tipping on the facetape and can be dimmed by long tipping.





Radium
Die Lichtmarke

Radium Lampenwerk GmbH

Dr.-Eugen-Kersting-Str. 6
51688 Wipperfürth

Telefon +49 (0) 2267 81-1
Fax +49 (0) 2267 81-353

www.radium.de
radium@radium.de